

## ARL 2-8823PGC/F

### Features:

1. 8mm Columnar Type
2. Green LED Lamp
3. Water Clear Lens
4. Lamp Trilby Without Stopper

### Spatial Distribution:

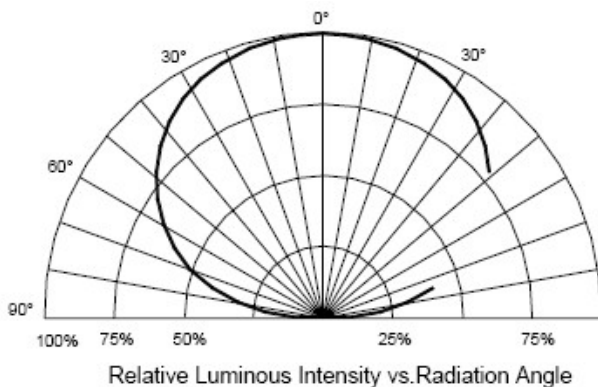

### Package Dimensions (mm):

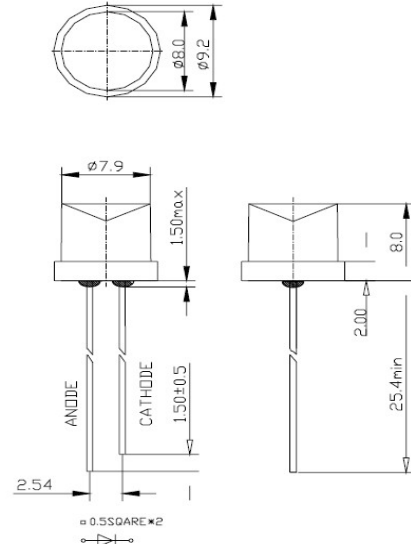

#### Notes:

1. All dimensions are in millimeters.
2. Tolerance is  $\pm 0.2\text{mm}$  unless otherwise specified.
3. An epoxy meniscus may extend about 1.5mm down the leads.
4. Burr around bottom of epoxy may be 0.5mm max.

### Typical Electrical & Optical Characteristics (Ta=25°C)

Items	Symbol	Condition	Min.	Typ.	Max.	Unit
Forward Voltage	$V_F$	$I_F=20\text{mA}$	2.8	3.0	3.6	V
Reverse Current	$I_R$	$V_R=5\text{V}$	-	-	50	$\mu\text{A}$
Dominant Wavelength	$\lambda_D$	$I_F=20\text{mA}$	520	-	530	nm
Luminous Intensity	$I_V$	$I_F=20\text{mA}$	4000	5000	-	mcd
50% Power Viewing Angle	$2\theta_{1/2}$	$I_F=20\text{mA}$	-	140	-	deg

### Absolute Maximum Ratings (Ta=25°C):

Items	Symbol	Absolute Maximum Rating	Unit
Forward Current	$I_F$	25	mA
Peak Forward Current*	$I_{FP}$	100	mA
Continuous Forward Current	$I_L$	20	mA
Reverse Voltage	$V_R$	5	V
Power Dissipation	$P_D$	120	mW
Derating Linear From 50°C		0.4	mA/°C
Operation Temperature	$T_{opr}$	-20~+75	°C
Storage Temperature	$T_{stg}$	-30~+85	°C
Lead Soldering Temperature	$T_{sol}$	Max.260°C for 5 sec Max.	

\*IFP Conditions: Pulse Width  $\leq 10\text{msec}$  duty  $\leq 1/10$

\*\*Tsol Conditions: 4mm from the base of the epoxy bulb

## Reliability Performance:

Test Classification	Test Item	Test Conditions	Test Duration	Sample Size	Ac/Re
Life Test	Life Test	Ta=25°C±5°C, IF=20mA	1000 (hrs)	30pcs	0/1
Environment Test	Thermal Shock Test	-10°C±5°C ↔ +100°C±5°C 5min. 10sec. 5min.	50 (cycles)	30pcs	0/1
	Temperature Cycle	-55°C±5°C ↔ +85°C±5°C 30min. 5min. 30min.	50 (cycles)	30pcs	0/1
	High Temperature & High Humidity Test	Ta=85°C±5°C RH=85%±0.5%RH	1000 (hrs)	30pcs	0/1
	High Temperature Storage	Ta=100°C±5°C	1000 (hrs)	30pcs	0/1
	Low Temperature Storage	Ta=-55°C±5°C	1000 (hrs)	30pcs	0/1
Mechanical Test	Resistance to Soldering Heat	Ta=260°C±5°C	5 (sec.)	30pcs	0/1
	Lead Integrity	0° ~ 90° ~ 0°	3 (times)	30pcs	0/1